



smaryd^{blue}

USER MANUAL [EN]



smaryd blue WATER BAR *zagora*TM

Please read this manual carefully before operating the device and subsequently keep the instruction manual safely and within close proximity to the device!

i NOTE: We reserve the right to make technological and functional changes or surface modifications to improve the functions and performances of our products.

smardy blue customer service & important Notes 3

Declaration of conformity 4

Notes & Safety 5

Preparation & device data 7

Scope of supply 8

Specification 9

Water filtration process 10

Water filtration 11

UV Sterilization 12

Installation & usage 13

Description of control panel 14

Features 16

Coffee and tea function 18

Installation options 20

First commissioning „mobile device“ 21

How to use quick connectors 22

Convert „mobile device“ to „mains-operated“ 23

Convert „mains-operated“ to „mobile device“ 26

Instructions for usage 27

Filter replacement 28

Decalcification & cleaning 30

Disinfection 34

Troubleshooting & Recycling 36

Customers FAQ 37

Guarantee 38

Space for your notes 39

Explanation of buttons 42

Notes on the use of this instruction manual:

For effective use of this manual it is necessary to firstly explain some symbols. You will need them to be able to follow the instructions and they highlight important information and notes.

Important icons:

- 

CAUTION: This symbol indicates possible dangers and important information when handling the device or components. It is always used when you need to be made aware of something urgently.
- 

TIP: This symbol stands for helpful information and notes which will help you in handling the product. Follow the advice for a smooth and effective use of the products.
- 

NOTE: Legal and general information are marked as hints, they clarify the explanations and procedures and make them comprehensible.
- 

EXPLANATION: Under this symbol you will find useful additional explanations concerning the use of the product. Here you will find FAQ's and particularities regarding the use of the device.



Dear Customer,

thank you very much for your purchasing the smardy blue drinking water device.

Easy, refreshing, tasty, pure – you will experience with smardy blue zagora™ water perfectly adjusted to your taste. Timeless design and easy operation are also part of the concept, as well as high-quality water filters and durable components. By regular maintenance and care you will constantly ensure a trouble-free and reliable operation.

Please read this manual carefully to ensure that you use the device properly. This manual describes problems that may occur during the use of the device. Preserve the therefore, always keep the manual and the warranty card in a safe place for future reference.

We hope you enjoy your smardy blue water bar.

The smardy blue Team

! ATTENTION: This unit was developed to filter tap water. Not use with water that is microbiologically questionable or without sufficient disinfecting the system. Our water bar filters organic compounds and impurities from the tap water. Rinse the system after longer periods of non-use (more than 3 days) according to the instructions (see note on page 27). Installation and service should be carried out by a professional. Incorrect installation may invalidate the warranty. The water bar is not for use by people (including children) with reduced physical abilities, sensory or mental abilities or a lack of experience and knowledge. This rule may only be deviated from if these people are under supervision or under the supervision of a person responsible for their safety and if this person has received instruction in the operation of the device. Position the device in such a way that it is inaccessible to children under 8 years of age (e.g. to avoid the risk of strangulation by the power cord).



For general information about smardy blue zagora™:

- ✓ Free expert advice before and after the purchase
- ✓ Service Hotline Phone: +49 (0) 8232 8088325 (chargeable)
- ✓ Service Video: smardy-blue.com/zagora-hinweise

EU Konformitätserklärung EU Declaration of Conformity

Wir, die Firma
We, the company

JustMore GmbH & Co. KG
Georg-Pfandzeller-Strasse 1
86830 Schwabmünchen
Deutschland/ Germany

erklären in alleiniger Verantwortung, dass das weiter unten genannte Produkt
declare under our sole responsibility that the following product

Geräteart/ type of product:

Wasseraufbereitungsanlage
water treatment device

Modell
model

Artikelnummer
article-no

weitere Angaben
further details

RS300-C

4053599146228

die grundlegenden Anforderungen der aufgeführten EU-Richtlinien erfüllt:

2014/35/EU Niederspannungsrichtlinie
2014/30/EU Richtlinie über die elektromagnetische Verträglichkeit
2011/65/EU Richtlinie zur Beschränkung bestimmter gefährlicher Stoffe in Elektro- und Elektronikgeräten
2009/125/EG Richtlinie über die Anforderungen an die umweltgerechte Gestaltung energieverbrauchsrelevanter Produkte

meets the essential requirements of the following EU-Directives:

2014/35/EU Low Voltage Directive
2014/30/EU Directive on Electromagnetic Compatibility
2011/65/EU Directive on the restriction of the use of certain hazardous substances in electrical and electronic equipment
2009/125/EC Directive for the setting of ecodesign requirements for energy-related products

angewandte Standards und Verordnungen/ applied standards and regulations:

EN 60335-1:2012 + AC:2014 + A11:2014
EN 60335-2-15:2016
EN 50106:2008

EN 55014-1:2006 +A2:2011 +A1:2009
EN 55014-2:2015
EN 61000-3-2:2014
EN 61000-3-3:2013

EN 50581:2012

Verordnung (EU) 1275/2008
Regulation (EU) 1275/2008

Bevollmächtigter zur Zusammenstellung der technischen Unterlagen:
Authorized person for technical documentation:

Name/ name: Astalosch, Marius, Geschäftsführer / General manager

Schwabmünchen,

02. April 2020
Datum/ Date

JustMore GmbH & Co. KG
Georg-Pfandzeller-Strasse 1
86830 Schwabmünchen
GERMANY
Unterschrift/ Signature

! ATTENTION: Non-compliance can lead to serious injury or even death.

- Do not make any changes to the installation and do not take it apart.
- Improper disassembly or modification can lead to malfunction and leakage. Do not leave any objects on the device – **Danger of overheating!** Do not place any heavy objects on top of the unit and do not put containers with water, medicines, food, small metal objects or highly flammable material over or on the device. If foreign matter enters the device, the housing could be damaged and cause toxic or dangerous substances to get in.

Introduction:

In the following you will find some important information on the installation area and installation requirements. For installation and operation please use the water bar exclusively original smardy blue components and accessories. An improper handling, installation and operation of the system can lead to health risks and lead to the loss of any warranty claims.

1. Water pressure:

- Water source: drinking water
- Pressure: maximum water pressure 3 bar in modus „mains-operated“
- Do not expose the device to excessive water pressure, this could damage the water supply lines. The recommended water inlet pressure is between 0,5 and 3 bar.

2. Power supply:

Power cable and plug are only suitable, tested and approved for this product.

! ATTENTION: Use provided power supply cable and do not operate the device with other commercial connection cables. Do not use the power plug with wet hands!

3. Troubleshooting for errors:

Immediately remove the power and water supply if the product is defective or there is a malfunction.

In such cases please contact our support team at info@smardy-blue.com or by phone **+49 (0) 8232 8088325 (chargeable)**.

4. Application and temperature range: 4 °C - 38 °C in dry, clean area.

Please protect the device from dirt, dust, external moisture and heat. Avoid direct sunlight – the water filter must not be installed in the area of direct solar radiation. The inlet water should have a maximum temperature of 38 °C, otherwise the reverse osmosis membrane could be damaged and lead to functional errors. Do not use the device in an ambient temperature below 5 °C and ensure that the water in the device cannot freeze to avoid broken supply lines and water loss. Don't leave the device permanently outdoors and thus avoiding premature aging of the water pipes and possible malfunctions. Do not leave the unit close to fire sources. Too high temperatures could deform the housing, lead to malfunctions and leakage of the device. Do not use the unit during operation of moving vehicles (e.g. car / boat / aircraft).

5. Transport of the water filtering system:

Make sure to empty the water tank before you tilt your device over an angle of 45 degrees. **Maintenance:** Do not open the unit yourself to repair it. Unauthorized opening of the system voids the warranty.

6. Accessories and filters:

Only use original accessories approved and tested by us.
Set up and install out of reach of children. Please make sure, that children cannot use and operate the system unattended.

7. Instructions for use:

- Do not use damaged plugs, loose sockets or plug connections.*
- Do not touch the power plug with wet hands.*
- Do not bend the power cord with force and do not lay it under a heavy object to prevent damage.*
- If the power cord is wet, remove the plug and leave it unplugged and dry completely before the next usage.*
- Unplug the unit before repairing, checking or replacing parts.*
- Do not use any sockets to which other equipment is connected. Use a separate power outlet for this unit only.*
- If you do not use the unit for a long period of time, empty the water container, and remove the power cord from the power outlet.*
- Do not attempt to repair the power cord.*
- Always remove dust and water from the pins and contacts of the power plug.*
- If the power cord is damaged, never replace the cord yourself.* Contact customer service to have it replaced.
- If water leaks from the machine, remove the power plug.* Please contact customer service.
- If the machine makes strange noises or smells, remove the power plug.* Please contact customer service.
- Unplug the power cord from the wall outlet before cleaning. Don't spray any water directly on the device when cleaning and do neither use cleaning gasoline nor thinner.*
- Do not move the machine by pulling the power cord.*
- Only connect the machine to a power supply that is connected to a RCD is equipped with an earth-leakage circuit breaker.*

! ATTENTION: *Otherwise, electric shock, damage to the unit or a fire could be the result.

Prior to the installation:

Read the instructions and check the space available to accommodate all the components to be installed. Check whether the inlet water pressure for a fixed mains connection is between 0,5 – 3 bar

! ATTENTION: This product is only suitable for TAP WATER.

Product description:

The smardy blue zagora™ is a reverse osmosis water system. It provides water in **four temperature ranges** to choose from, to meet all your needs

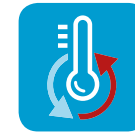

- *filtered drinking water at room temperature*
- *warm water*
- *hot water*
- *boiling water*



For this purpose, „normal“ tap water is poured into the outer tank and filtered by means of **sediment filter, activated carbon filter and a RO membrane**, of any harmful ingredients that may be present in the water like **nitrate, lime, drugs, viruses, bacteria, heavy metals, microplastics, pesticides, chlorine, etc.**

Technical data:

Connection options:	Table-top without fixed connection or also grip-bound
Change interval filter:	6 months
Change interval membrane:	12 months
Areas of application:	household, kitchen, office, mobile
Filling speed:	1.250 ml / minute
Daily capacity:	280 Liter / day
Filter stages:	5 stages integrated in 3 Quick-Change-Filter
Membrane:	75 GPD RO membrane
Power connection:	220 – 230 V, 50 / 60 HZ
Heating power:	2.050 W
Drinking water tank:	4 Liter filling tank, 1 Liter storage tank
Required pressure:	0,5 – 3 bar
Booster pump:	with booster pump

Producer RO membrane: DOW Chemical FILMTEC™ (Made in USA)

SCOPE OF SUPPLY

Product details:

Product: Drinking water device
Brandname: zagora™
Model: RS300-C

Scope of supply:



SPECIFICATION

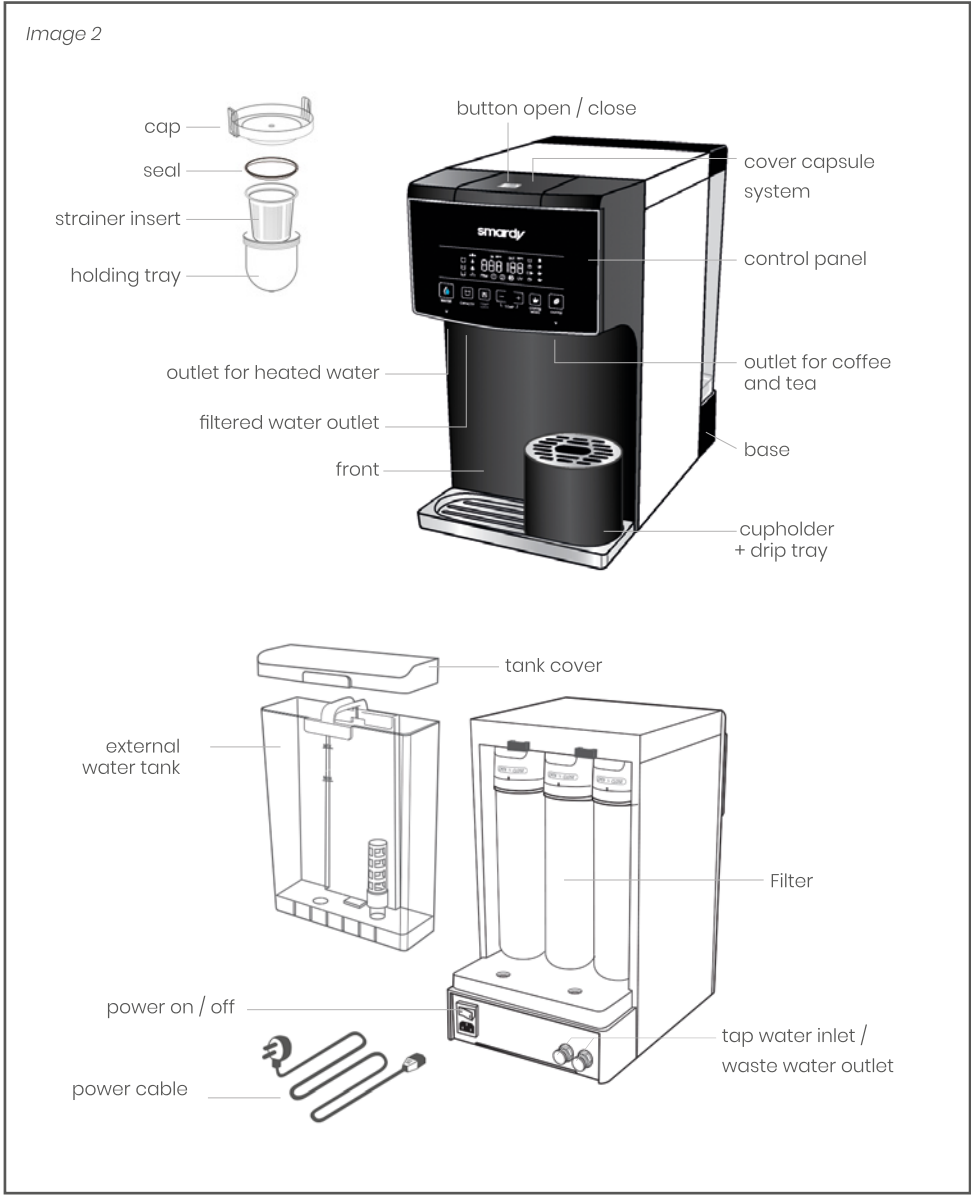

NOTE: We reserve the right to make technological and functional changes or surface modifications to improve the functions and performances of our products.

NOTE: Please observe the stickers with instructions for care and maintenance. These are located on the water tank and water tank lid and should be left on the device.



The heart of the smardy blue zagora™ forms the innovative 5-stage filtration technology.

For this we rely exclusively on high-quality and proven technology.

Three steps to perfection:

Many water coolers have a simple filter. To obtain pure water, more is needed. That is why smardy blue uses three highly developed filter technologies that guarantee the purity of your water.

STEP 1: COMPOSITE MICRO FILTER Composite Micro Filter

Starting with a **sediment pre-filter**, consisting of a 5 micron PP filter and activated carbon filter, the system first removes sediment, rust, asbestos, sand, mud, humic substances and other larger residues.

This is where activated carbon plays a central role.

Activated carbon is a very porous, fine-grained carbon, which is gained from coconut shells by using a special thermal treatment.



STEP 2: RO MEMBRAN DOW FILMTEC™ 75 GPD 0,0001 Micron Filtersystem

In the next step, the queen of the filtration processes is used: the **reverse osmosis RO membrane DOW FILMTEC™ 75 GPD**. With its help pollutant-free water is produced in its purest form.

Microbiologically safe: QuickChange RO membranes keep microbiological impurities such as heavy metals, uranium, hormones, chemicals, bacteria, viruses, pesticides and medicines at bay.

Made in USA: DOW FILMTEC™ is the world's leading manufacturer of RO membranes. For your benefit we rely on the No.1 in component selection and thus achieving such extraordinary results.

STEP 3: COMPOSITE ACTIVATED CARBON FILTER Activated Carbon Filter

The third stage is an 1 micron activated carbon block filter and PP filter. The highly effective and sustainable filter keeps chlorine, chemicals and other harmful organic compounds at bay. It additionally improves the taste of water.

Alternatively, it is possible to install the third filter cartridge according to your wishes and, depending on requirements, enrich the purified water with minerals, revitalizing trace elements or alkaline.



Image 3

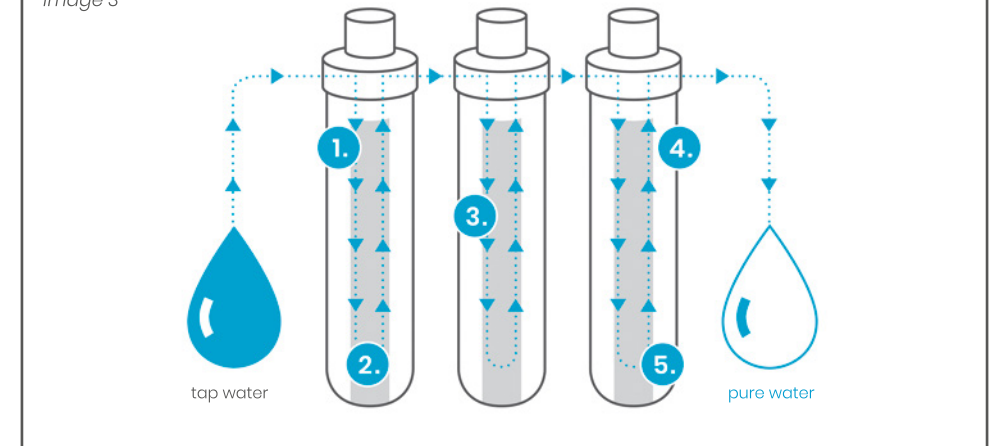

picture smardy blue filter steps

FILTER TECHNOLOGY:

- 1. PP filter 5 micron:** removes sediment, rust, asbestos, sand, mud and humic substances.
- 2. Activated carbon filter:** retains heavy metals and chlorine.
- 3. RO membrane DOW FILMTEC™ 75 GPD / 0.0001 Micron:** removes nitrate, pesticides, drug residues, uranium, lime, bacteria, viruses, hormones, chemicals and microplastics
- 4. + 5. 1 micron activated carbon block filter and PP filter:** reduce chlorine and chemicals and improves odor for better taste, adjusts the pH value.

Here you will find more information: smardy-blue.com/filterungsprozess

i NOTE: During the filtration process, waste water is produced (ratio 2:1 up to 3:1). This water is required to flush all pollutants out of the filters. This achieves, that no pollutant residues of any kind remain in the device and no concentrated pollution is in the filter cartridges. Therefore used cartridges can be disposed of in residual waste (not special waste).

💡 TIP: Usage of waste water. You can use the waste water to clean the toilet, the house or laundry etc.

! ATTENTION: Do not use the waste water for drinking or cooking!



Sterilization by UV-Licht: UV light is the solution for contaminated water by germs, bacteria and fungi. **smardy blue UV systems offer the perfect protection** and provide safe access to clean water.

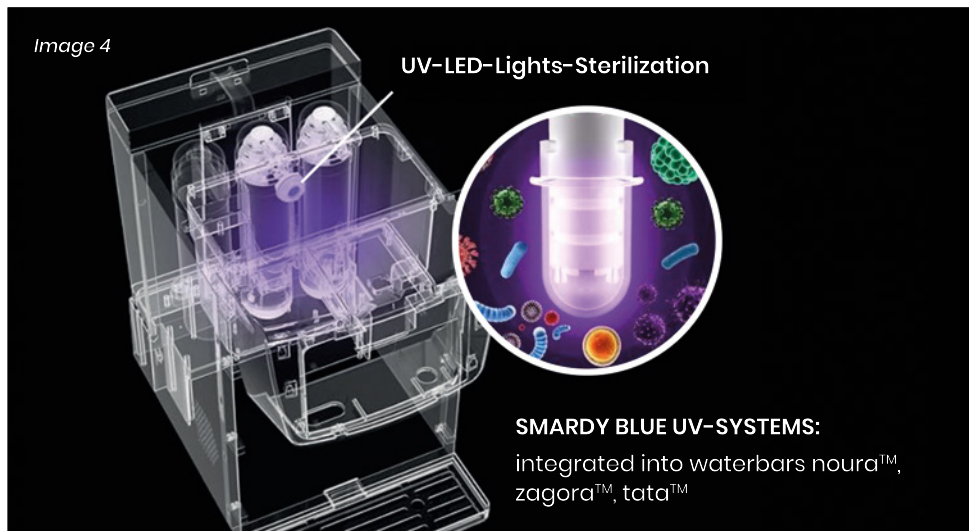

Why UV light?

UV light is the solution for contaminated water by germs, bacteria and fungi.

Background knowledge:

Microorganisms such as bacteria, moulds, yeasts and viruses cannot multiply. The cleaning effect is achieved at wavelengths below 285 nm, whereby the maximum effect is achieved at 265 nm.

Effect:

smardy blue LED UVC-germination lamps emit light at 275 nm (+/- 10 nm), near the maximum effectiveness and are also ozone free.

Technical data:

smardy blue LED UVC-disinfection lamps provide a peak intensity at 275 nm (+/- 10 nm), which is ideal for highly effective sterilization of water

- Low pressure semiconductor lamp
- LED-UVC with high UV intensity and permanent sterilization
- Single UV-C Peak @ 275 nm
- High efficiency (30 % UV-C output)

Here you will find more information: smardy-blue.com/uv-sterilisation

1. Remove the product packaging.
2. Place the drip tray in the position holder at the front of the machine.

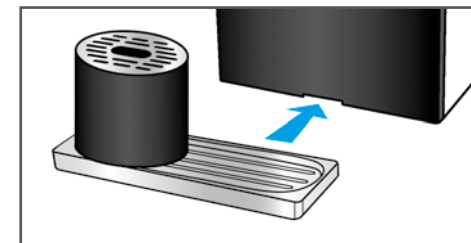

3. **Start-up:** connect the power cable to the back of the machine. Connect the power cord to the power supply. **DO NOT** remove the two plugs on the back and this avoiding leakage of water. The connections are required for the fixed line installation.

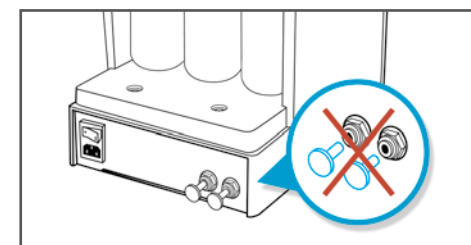

4. Fill tap water into the water tank up to the mark between MAX and MIN. Make sure that the sieve in the tank is firmly attached to the right position. If necessary, attach it to the specified position.

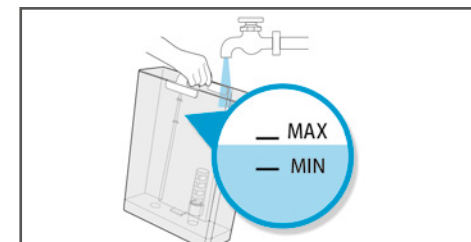

5. Place the water tank back in the machine. Make sure that the hooks are in the mounting lugs during inserting.

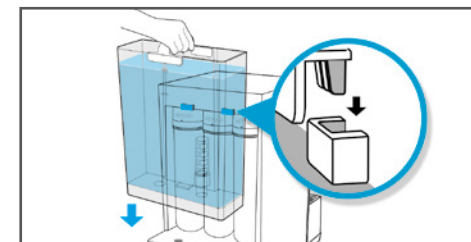

6. The machine starts automatically with the water treatment. As soon as the tank display shows „Water treatment“ on, put the cap on the tank.

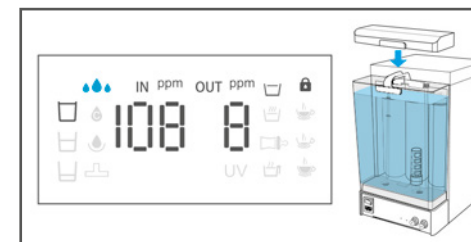

DESCRIPTION OF CONTROL PANEL



Control Panel

Buttons (functions on pages 16 – 17)



Symbol	Display mode	Explanation
	Symbol lights up.	Water outlet – starts and stops the water outlet when pressed.
	Symbol lights up.	Select the quantity of water outlet by pressing the „CAPACITY“ buttons“ (large cup: 0,5 l / medium cup: 0,25 l / small cup: 0,15 l).
	Symbol lights up.	Water treatment in progress.
	Symbol lights up.	Flashes when the filter life has expired and informs you that the filter needs changing. Please use only compatible filters (see page 26).
	Display digit OUT.	Displays TDS * value for filtered water (ppm).
	Display digit OUT.	appears when the decalcification process is activated.

Symbol	Display mode	Explanation
	Display digit IN.	1. Displays TDS * value for input water (ppm) 2. Displays the temperature of the discharge water when water button is pressed.
	Symbol lights up.	Reminder to clean and decalcify the internal components. Please carry out the decalcification and cleaning process according to page 28 – 31.
	Symbol lights up.	If there is insufficient tap water or the TDS * value of the of unfiltered water is too high. Symbol disappears when the water treatment is completed.
	Symbol lights up.	Indicates the operating mode – fixed water connection. Press and hold the „CAPACITY“ and „TEMP/LOCK“ buttons simultaneously for 5 seconds to switch to the mode (see page 23).
	Symbol lights up.	Child lock active, no hot water available. Press and hold the „TEMP/LOCK“ button to unlock.
	Symbol lights up.	Water at room temperature (ca. 15 ~ 22 °C).**
	Symbol lights up.	Boiling water (90 ~ 95 °C).** The temperature can be changed by pressing the „TEMP/LOCK“ and „- + TEMP“ buttons.
	Symbol lights up.	Hot water for tea (70 ~ 90 °C).** The temperature can be changed by pressing the „TEMP/LOCK“ and „- + TEMP“ buttons.
	Symbol lights up.	Warm water for baby food (40 ~ 70 °C).** The temperature can be changed by pressing the „TEMP/LOCK“ and „- + TEMP“ buttons.
	Symbol lights up.	UV function running (see page 12).
	Symbol lights up.	in coffee mode – medium (low water quantity); selection with „COFFEE MODE“ button.
	Symbol lights up.	in coffee mode – strong (medium water quantity); selection with „COFFEE MODE“ button.
	Symbol lights up.	in coffee mode – light (high water quantity); selection with „COFFEE MODE“ button.

*TDS – meter measures the electric conductivity of the water.
**Actual output value depends on input temperature.



Water outlet:

Place your water container under the left outlet nozzle and select the water type. Then press the „water outlet“ button to receive water from the machine.

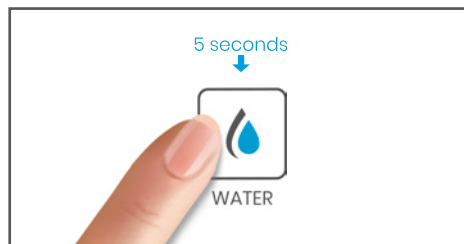

Setting the child-proof lock:

The standard setting of the machine is locked for „boiling and hot water“. To turn this setting off, press and hold the „TEMP/LOCK“ button for 5 seconds. To reset the parental control press the „TEMP/LOCK“ button again for 5 seconds.

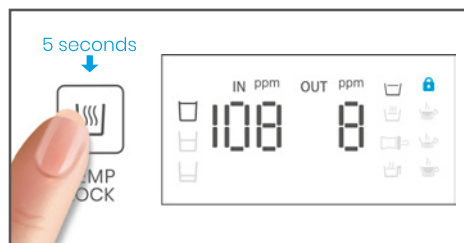

Temperature levels:

You can change the temperature levels by pressing the buttons „TEMP/LOCK“ and „TEMP“ various temperature levels select if the parental control is deactivated. By pressing the „water outlet“ button the water is then mixed with the desired temperature output.

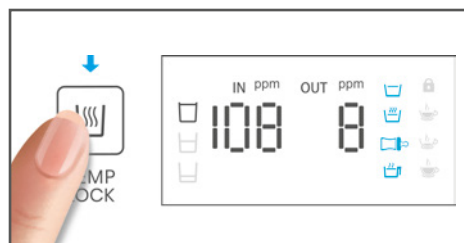

Select water temperature:

Hold the „TEMP/LOCK“ button to the desired water temperature to select. There are three temperature levels (actual output value depends on input temperature):

- Warm water: 40 ~ 70 °C
- Hot water: 70 ~ 90 °C
- Boiling water: 90 ~ 95 °C

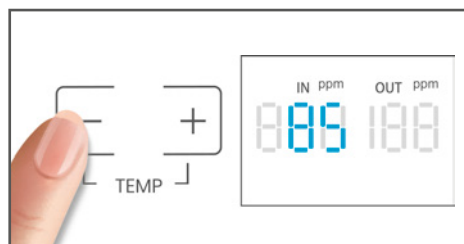

Selection of the water quantity:

Press the „CAPACITY“ button to choose between the water quantities:

- Big cup: 0,50 l
- Middle cup: 0,25 l
- Small cup: 0,15 l

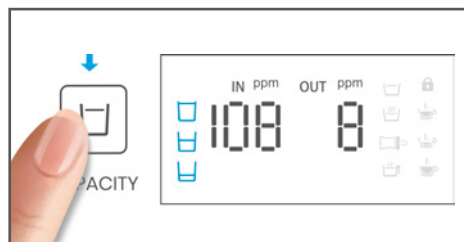

Coffee and tea function:

Select the strength of coffee or tea by pressing the „COFFEE MODE“ button (childlock must be unlocked, see page 15, item 5):

- Medium coffee/tea mode: ca. 140 ml
- Strong coffee/tea mode: ca. 100 ml
- Light coffee/tea mode: ca. 180 ml

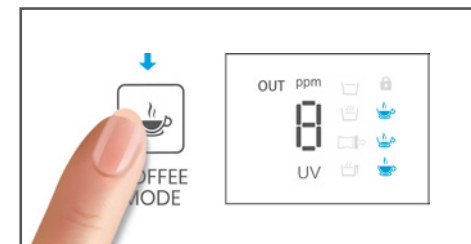

Coffee and tea:

After adding the coffee powder or tea into the capsule system, (see pages 18 - 19) press the „COFFEE“ button to obtain the desired quantity of coffee or tea. Press the „COFFEE“ button a second time to increase the water quantity if necessary.





The early bird catches the worm.

Tea or coffee for breakfast is part of the morning ritual for many people. One sits at the breakfast table, perhaps reading a daily newspaper and enjoying a hot cup of one's favourite drink. To ensure that nothing is missing during preparation and of course while drinking, smardy blue has an additional function integrated to make your morning delight as simple and easy as possible.

Please note the following procedure for perfect tea and coffee enjoyment:

1. Cleaning:

Place a cup (at least 250 ml capacity!) under the right-hand outlet nozzle and press the „COFFEE“ button for 5 seconds. This will preheat and clean the inner tubes and the capsule system.

2. Preparation:

Press the cover button. The cover now opens automatically and flips up. Then remove the capsule system from the machine. Unscrew the lid of the capsule system and remove the strainer.

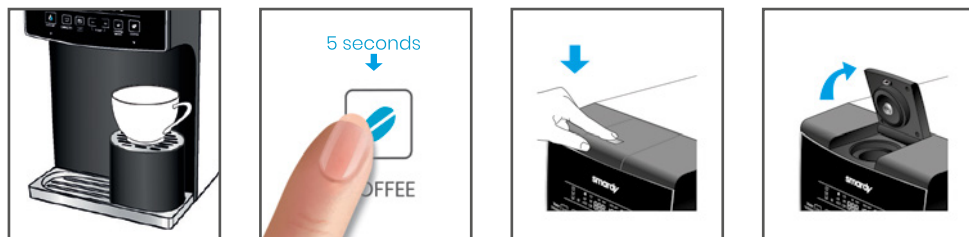

Coffee preparation: pour ground coffee powder into the strainer (filling level to max. upper edge). Place the strainer in the capsule system and close the cap.

TIP: We recommend handmade coffee powder (grind: medium).

Tea preparation: Place loose tea in the strainer (filling level to max. upper edge). Place the strainer in the capsule system and close the cap.

3. Preparation:

Place the capsule system in the machine and close the cover.

- Then select the water quantity (strong, medium, soft) according to your personal taste and touch the corresponding symbol.
- The preparation starts by pressing the „COFFEE“ Button.

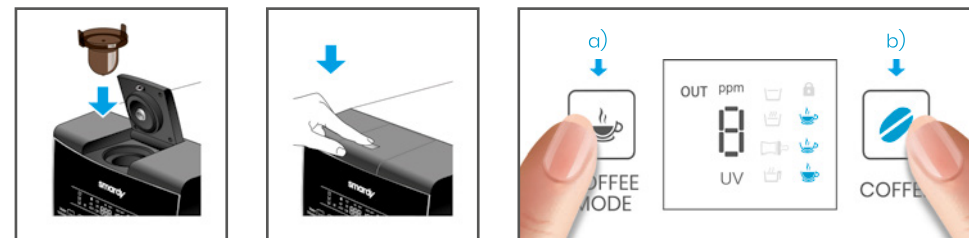

4. Cleaning:

In order to ensure that you can enjoy your favourite drink for a long time, we recommend cleaning the capsule system after each use. To do this, remove the capsule system (**please pay attention to heat when removing the sieve!**), pour out the residue and rinse off with clear water. Alternatively, the capsule system can also be cleaned in a standard dishwasher.

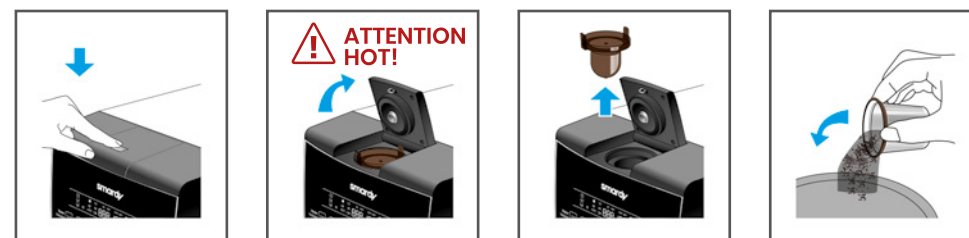

ATTENTION: Do not use instant coffee or solid instant drink granulate to avoid clogging or overflowing of the capsule system.

- The preparation function must be unlocked and enabled before selection.
- Do not open the main cover of the capsule system during the preparation process to avoid burns or irritation at high temperatures.
- Tea can be prepared several times.

NOTE: Before using the coffee and tea system for the first time or after a long period of time, it is necessary to flush and clean the internal pipes and the capsule system. To do this, place a cup under the right-hand outlet nozzle and press and hold the „COFFEE“ Button for 5 seconds.



The smardy blue zagora™ water bar is available in the variants „fixed water connection“ and „mobile water connection“. An installation as a fixed water connection is possible at a later date.

You will find more information and items for installation as fixed water connection here: smardy-blue.com/festwasseranschluss

Image 5

Fixed water connection:

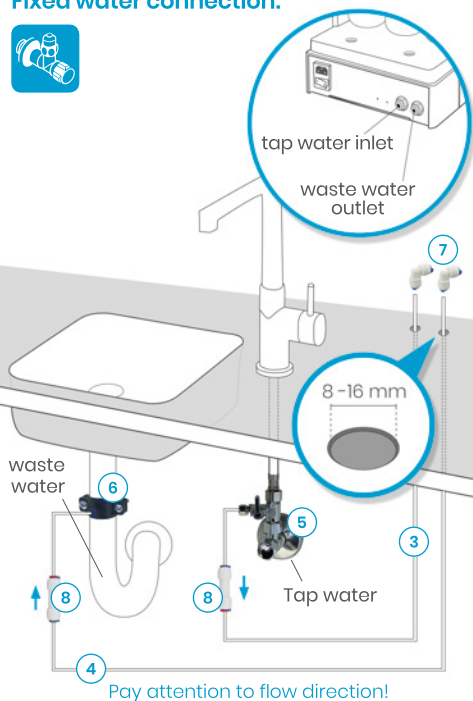

- ① smardy blue drinking water device
- ② Power cord
- ③ Hose for water inlet
- ④ Hose for water outlet

Mobile water connection:



- ⑤ T-piece adapter
- ⑥ clamp to sewage syphon
- ⑦ 90° angles (2 pcs.)
- ⑧ Check valve (2 pcs.)



Set up:

First remove all packaging material. Place the water bar at desired place and install the drip tray. Connect the power cord and start the machine using the power button. Remove the outer tank, and fill it with 4 litres of cold tap water. Put the outer tank back into the machine. The filtering process starts automatically.

i NOTE: before you consume the water, it is necessary to flush the new filter and the inner tank. Therefore let at least flow **3 FULL WATER TANKS** through the device.

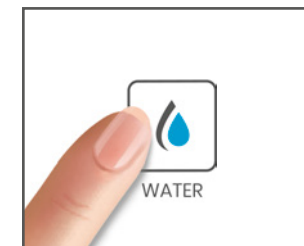

1. Water outlet: place your water container under the left exhaust nozzle.
2. Now briefly press the water button, to get water from the machine
3. Operate the water button again, to stop the water outlet.

! ATTENTION: Do not remove the water tank during water treatment to prevent malfunction and damage to the filter system. Empty the waste water regularly („⚡“ symbol flashes) and do not fill any water into the tank from the top.

Instruction for changing water / fill up water tank:

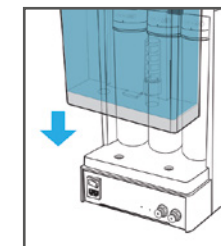
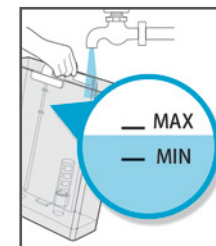
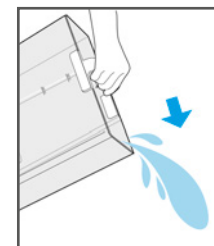
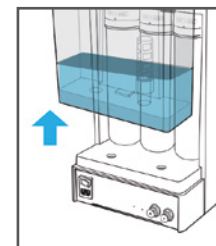

1. Remove water tank from device.
2. Empty the waste water regularly.
3. Refill with fresh tap water.
4. Put water tank back into device.

HOW TO USE QUICK CONNECTORS

i NOTE: The connections on the back of the unit and the fittings of the connection set are equipped with 6 mm – 1/4" quick connectors (Quick-Connect) for easy handling

No special tools are required to assemble the fittings (see image 6). However, we recommend using a smardy blue cutter (included in the separately available connection set) when cutting the connection hose to length.

How to use quick connectors:

Image 6

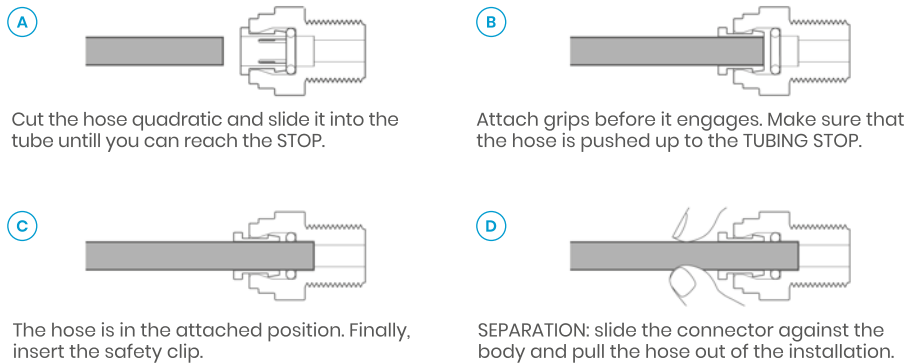

Each Quick-Connect connector is equipped with a special safety clip to secure and seal it. After assembly, please check that the clips are present and correctly seated (see image below). Dimension of the hose is ca. 19 mm.

i NOTE: Please keep the plugs for later use in a safe place.

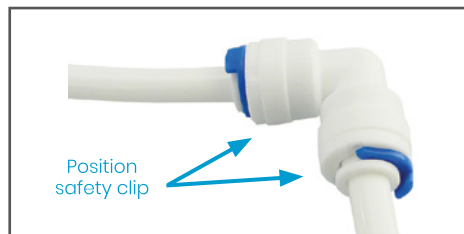
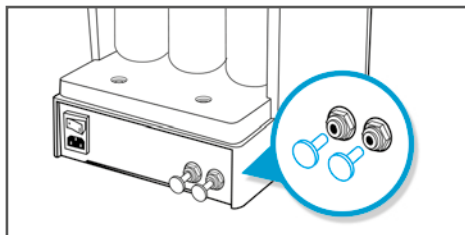

CONVERT „MOBILE DEVICE“ TO „MAINS-OPERATED“



i NOTE: For immediate installation in fixed water without prior mobile no need for installation steps 1– 2!

1. Remove the water tank and emptying the system and the internal water tank completely (see page 27).
2. Power off and remove power grid.

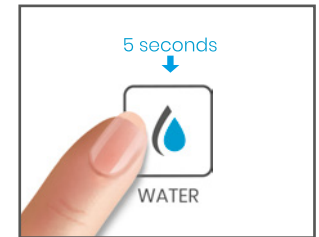
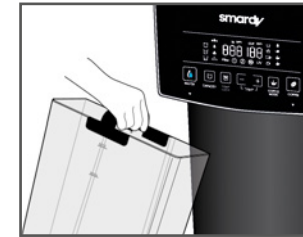
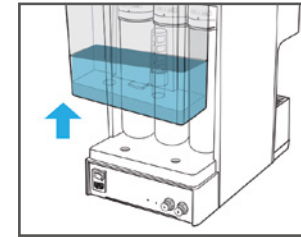

! ATTENTION: These installation steps are VERY important and must be carried out in the correct order.

First remove the two plugs at the back of the unit (image 6, point D: Removal of plugs) and insert the two connection pieces (no. 7) with the help of two pieces of pipe cut to the length of 5 cm.

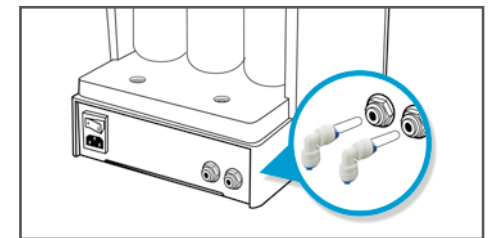
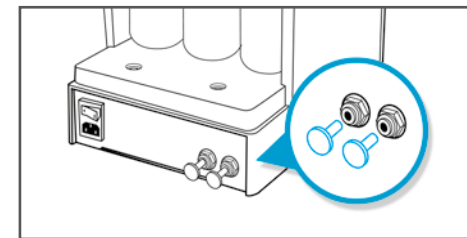

i NOTE: Please keep the plugs for later use in a safe place.

3. Turn the unit 90 degrees and place it on one side. Open the cover on the bottom with the help of a screwdriver.

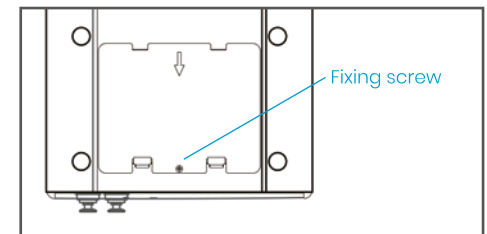

4. Then turn the two water valves by 90 degrees.
5. Close the cover on the bottom and fasten the screw.

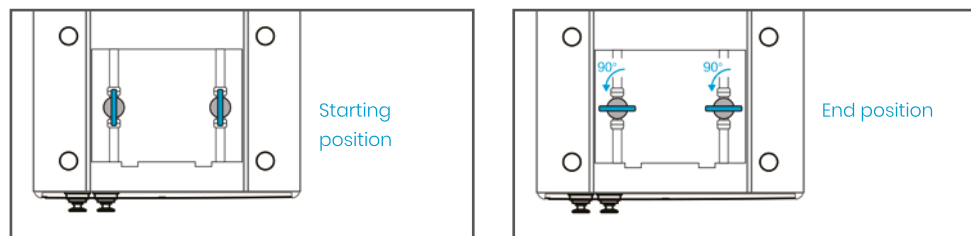

6. Installation of water connections:

- Turn off the water and disconnect the cold water supply at the angle valve. Install the adapter T-piece (no. 5) and connect the previous cold water supply of the kitchen faucet back to the new adapter T-piece.
- Now connect the non-return valve (no. 8 – observe flow direction, image 5) with an approx. 10 – 15 cm piece of the connecting hose (image 5 and image 6, point A and B) on the adapter T-piece.
- Mark the desired position of the black drain clip (no. 6) on the drain fitting above the odour trap bend.
- Drill an 6 mm hole in the drain fitting and install the black drain clamp (no. 6) so that the connection is centred over the hole.
- Now connect the non-return valve (no. 8 – observe direction of flow, image 5) with help of a 10 – 15 cm piece of the connecting hose (image 5 and image 6, points A and B) on the drain clamp (no. 6).
- Select a suitable position for the water bar. Drill two 8 mm holes into the worktop or the upper shelf of the sink. Make sure that the connections under the boreholes are accessible (image 5).
- When installing the two stainless steel feedthroughs (available separately – not included in delivery), two holes with a diameter of 16 mm will be needed.
- Now connect the connection angle (no. 7 / see image 5) with a cut-to-size connecting hose (no. 3) with the already installed check valve (no. 8) on the water inlet (no. 3).
- Connect the connection angle (no. 7 / see image 5) with a cut connecting hose (no. 4) with the already installed check valve (no. 8) on the water drain (no. 4).

- Place the water bar. Check all hoses and connections and make sure that all hoses are firmly connected and bend free.
- Open the cold water supply at the angle valve and the adapter T-piece and check the system, hoses and connections for leaks.
- Connect the power cable (no. 2) and switch the system on using the power button.
- Press the „CAPACITY“ and „TEMP / LOCK“ buttons simultaneously for 5 seconds. Change the system from water tank mode to fixed connection mode (the control panel shows „“, if the change was successful).

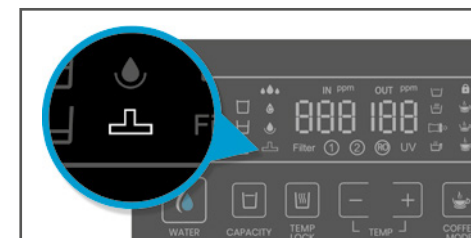
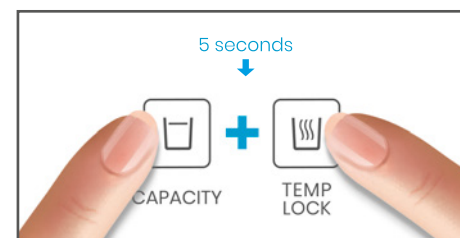

7. Put water tank back into device.

! ATTENTION: Before you consume the water, it is necessary to flush the new filter and the inner tank. Therefore let at least flow 3 FULL WATER TANKS („mobile device“) through the device or let out 6 LITER FILTERED WATER at water outlet („mains operated“). See notes on page 21.

TIP: The installation should be performed by an expert. Here you will find more information and explanatory videos (see information on page 20): smardy-blue.com/festwasseranschluss

i NOTE: Prevention of malfunctions. Do **not** remove the water tank while the water treatment runs (if „water treatment “ lights up). **This way you avoid malfunctions and damage to the filter system.**



1. Press the „CAPACITY“ and „TEMP / LOCK“ buttons simultaneously for 5 seconds. Change the system from water tank mode to fixed connection mode (the control panel shows „“, if the change was successful).
2. Remove the water tank and empty the device completely (see page 27).
3. Switch off the device and remove the power plug.
4. Turn off the water and disconnect the cold water supply at the rear.
5. Disconnect the waste water pipe at the rear of the unit.
6. Insert the two plugs into the open connections and insert the blue safety clips.
7. Turn the unit 90 degrees and place it on one side. Open the cover on the bottom with the help of a screwdriver.
8. Then turn the two water valves by 90 degrees.
9. Close the cover on the bottom and fasten the screw
10. Connect the power cable (no. 2) and switch the system on using the power button.
11. Fill with fresh tap water and put back into device.

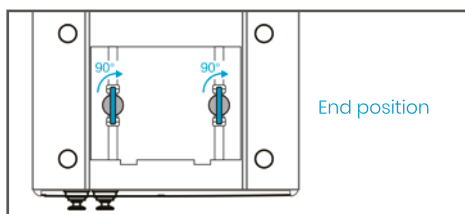
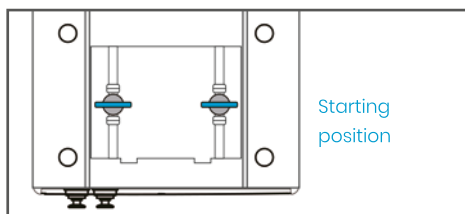
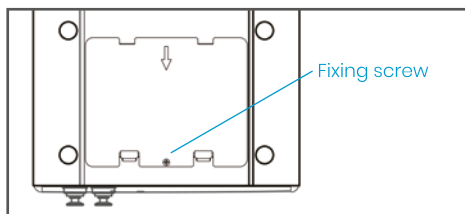
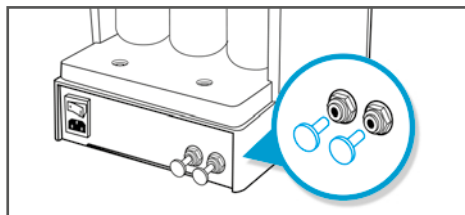
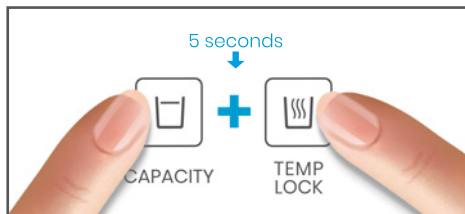

For a changeover to „mobile connection“, the water inlet (no. 3) and water outlet (no. 4) must be closed with a plug to prevent water leakage. To remove the hose again, you must first remove the safety clip (see page 22).

Empty the device:

In case of prolonged non-use you should empty the device completely.

Remove water container and place under the left outlet nozzle and press the „water outlet“ button for 5 seconds to empty all water from device. Press „Water outlet“ again to stop this function.

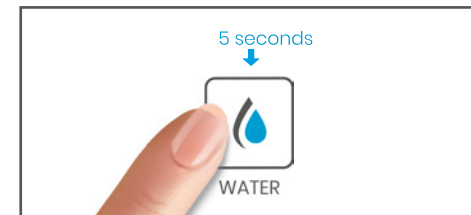

Procedure in the event of prolonged non-use:

- **In case of absence 1 - 2 weeks:**
Before you consume the water, it is necessary to flush the new filter and the inner tank. Therefore let at least flow **3 FULL WATER TANKS** („mobile device“) through the device. or let out **6 LITER FILTERED WATER** at water outlet („mains operated“). **See notes on page 21!**
- **In case of an absence of more than 6 weeks: Disinfection (see page 34) and a filter change are also necessary (replace filter stages no. 1 and no. 2, see page 28).**

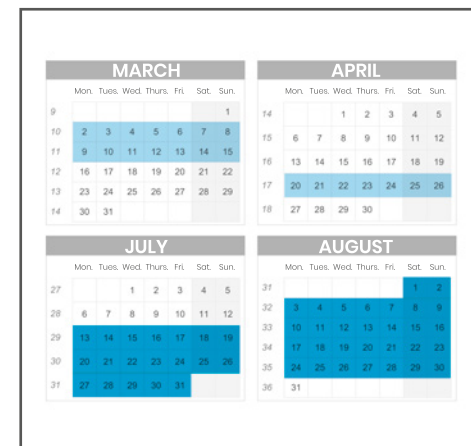

! ATTENTION: In case of prolonged non-use cut power grid and water connection (in fixed water connection) and place in a dry and clean area. In recommissioning please flush and maybe disinfect device.



6/12
months



smardy-blue.com/zagora-filterwechsel

Reminder: Filters need to be changed, if the effectiveness limit is reached. The necessary filter exchange is automatically displayed with the filter number to be exchanged accordingly appears on the display.



i NOTE: When filters are replaced, a decalcification / cleaning must be performed.

1. Turn the power off and remove the power cord. Remove the water tank. Remove the old filter and insert the new filter. **(Turn left to open! Turn right to close!)**

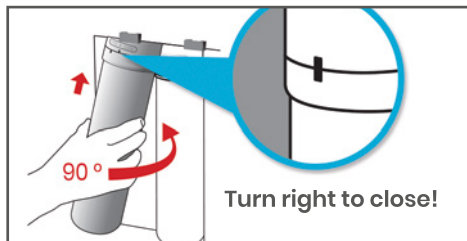
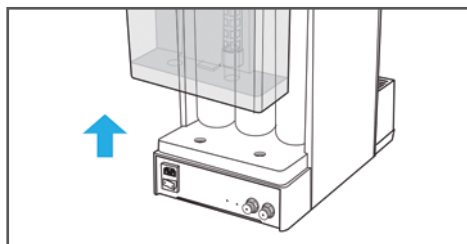
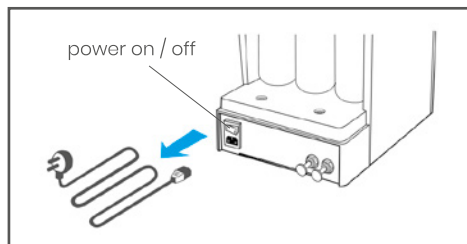

2. **Reset the display:**
(„Reset“ the filter change intervals.)

Reset the display to switch off the illuminated „filter“ symbols. Switch on the machine and hold the „CAPACITY“ and „water outlet“ buttons at the same time for 5 seconds.

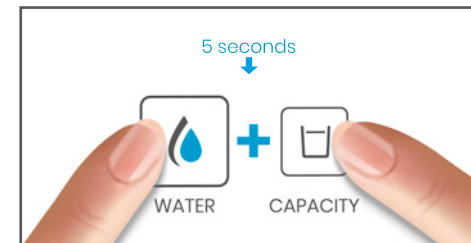

3. **Reset the display in advance:**

If you need to replace the filters before the filter has reached the end of its service life, you can reset the filters by means of the filter indicator as follows:

- a) Hold the „CAPACITY“ and „water outlet“ buttons at the same time for 5 seconds to enter the reset mode.
- b) Press the „CAPACITY“ button and select the replaced filter number. Press and hold the „water outlet“ button for 5 seconds to complete the reset after the exchange.
- c) To exit the reset mode, press the „CAPACITY“ and „water outlet“ buttons briefly. And the reset mode is automatically stopped after 10 seconds.

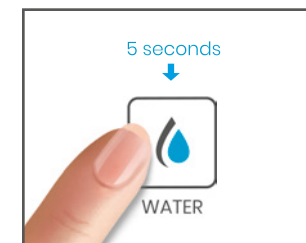
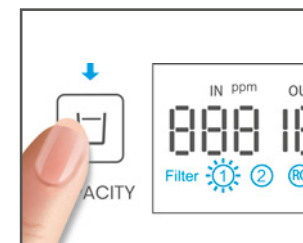
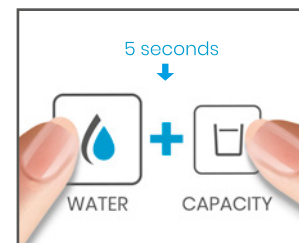

i NOTE: When the filter no. RO is replaced, a cleaning must be performed.

! ATTENTION: Before you consume the water, it is necessary to flush the new filter and the inner tank. Therefore let at least flow 3 FULL WATER TANKS through the device (see notes on pages 21).



Decalcification: Clean and decalcify your water bar regularly. The automatic smardy blue descaling program helps with the care and prolongs the lifetime of the device.



smardy-blue.com/zagora-pflege

NOTE: Depending on the hardness of the water in your region, the quicker deposits and contamination form. The harder the water, the faster these deposits form. For perfect care and protection it is necessary to clean and to decalcify the inner components of the smardy blue zagora™ at least **every 3 months** or when it lights up from symbol „☹️“. Please read these instructions carefully before descaling, cleaning and putting it into operation again. For the descaling and cleaning process please use only the specially developed **smardy blue Save & Clean special cleaner** (optionally available – not included in delivery).

The decalcification / cleaning only works in the „mobile connection“ state! Notes on converting from „fixed water connection“ to „mobile connection“ can be found on page 26.

! ATTENTION: SAFETY INSTRUCTIONS (smardy blue Save & Clean decalcification liquid)! Please read the use and safety instructions on the package insert.

1. Switch off the device and remove the power cord. Remove the water tank from the unit and empty the waste water in the outer water tank completely.

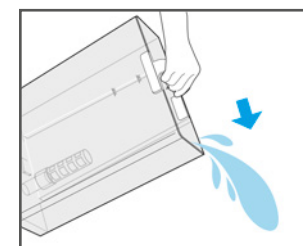
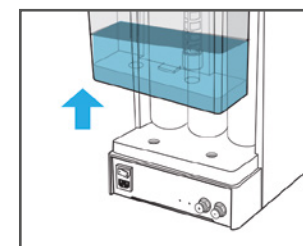
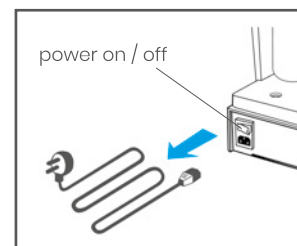

2. Remove the filters no. 1, 2 and replace them with the cleaning cartridges D. Remove the filter no. RO and replace it with the cleaning cartridge E. **Please pay attention to the direction of rotation when removing and inserting the cartridges!**

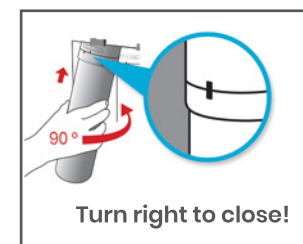

3. **Prepare and fill in the cleaning solution:**
 - We recommend preparing the cleaning solution from the following ingredients:
100 ml smardy blue Save & Clean special cleaner
+ 900 ml pure water (prepare in advance).
 - Pour the **cleaning solution** into the outer tank, connect the power cord and switch on the unit again.

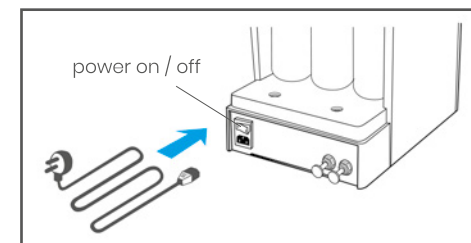

4. Then press the „CAPACITY“ and „+“ buttons simultaneously for 5 seconds until shown the „[]“ symbol and insert the outer tank into the system.

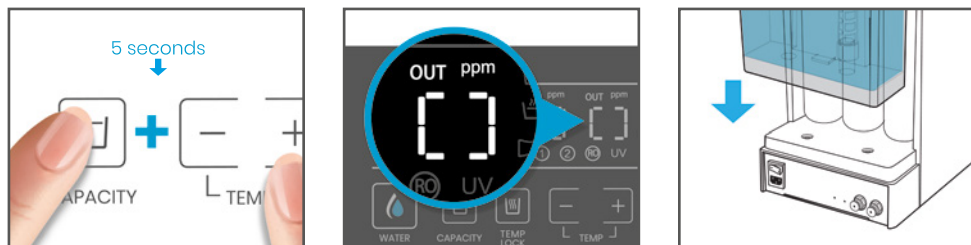

i NOTE: The cleaning process now starts automatically and takes about 1 hour. When the process is complete, the „C“ symbol flashes on the display.

5. Remove the water tank from the appliance and empty the remaining water in the outer water tank completely. Then fill tap water into the tank and put the water tank back into the system.

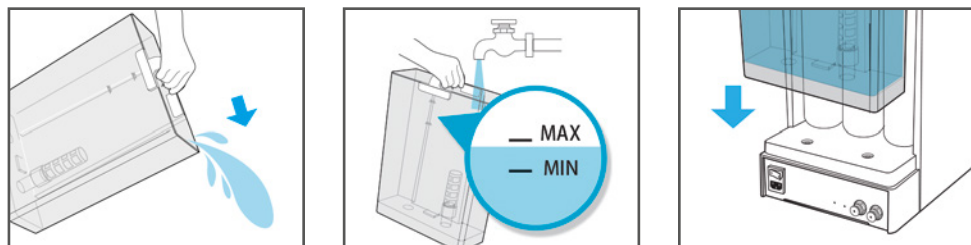

6. **Let the appliance run until the „C“ symbol flashes!** Remove the water tank out of the machine and empty the remaining water in the outer water tank completely.

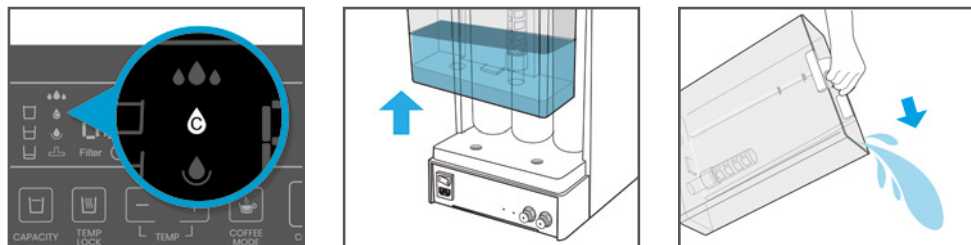

7. Switch off the device and remove the power cord. Replace the cleaning cartridges (2x D, 1x E) through the filters no. 1, 2 and RO by inserting it in the indicated direction. Fill tap water into the water tank.

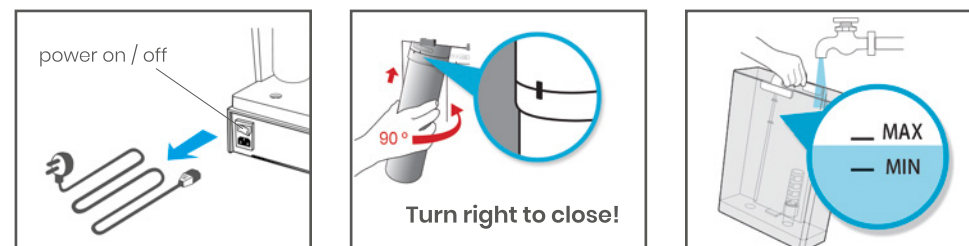

8. Place the water tank back into the system. Now connect the power cable and switch the unit on again.

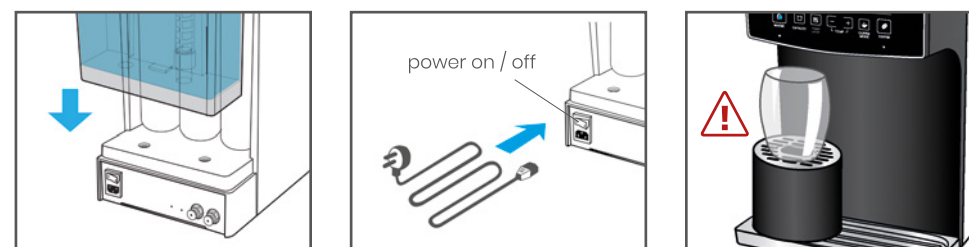

! ATTENTION: Before you consume the water, it is necessary to flush the new filter and the inner tank. Therefore let at least flow 3 FULL WATER TANKS through the device. This waste water is not for consumption!

i NOTE: General hygiene measures! Change the water in the outer tank regularly, ideally once a day. All external surfaces and the drip tray should be wiped with a damp cleaning cloth once a week. Use mild, disinfectant products for this purpose – no paint removers or alcohol products. You can also clean the drip tray in a regular dishwasher. We also recommend regular use of disinfectant spray to clean the display and the front water outlet. To do this, spray the display and the lower side with disinfectant spray and let it rest. **Important: Do not wipe off the disinfectant spray!**

! ATTENTION: Only carry out all of the cleaning activities without power (remove power cable)!

DISINFECTION



As for all living things, water is the most elementary basis for germs and bacteria. Especially in stagnant water they find optimal living conditions under which they multiply well. Here you will find more information:

smardy-blue.com/zagora-pflege

i NOTE: Disinfect to remove microorganisms that are harmful to health when changing the filter, it is best to clean your system BEFORE you start. change to new filters at least every 3 months. Read the instructions carefully, before you disinfect the device and start it up again. **The decalcification / cleaning only works in the „mobile connection“ state!** Notes on converting from „fixed water connection“ to „mobile connection“ can be found on page 26).

1. Empty the unit completely (see page 27).

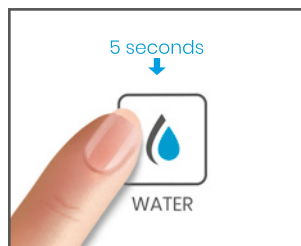
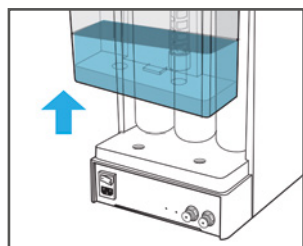

2. Switch off the device and remove the power cord. **Replace the filters no. 1 and 2 with the cartridges D (purple label – included in delivery)** by turning into the direction as shown. Filter no. RO remains in the unit.

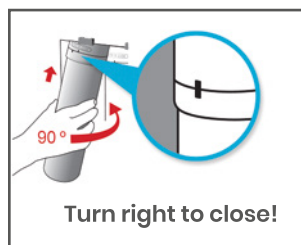
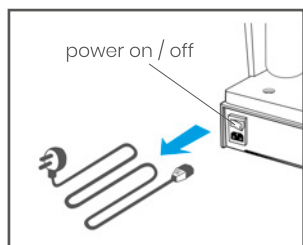

3. **Preparing and filling the disinfectant solution:**

Fill tap water (about 4 litres) into the tank and then add the **smardy blue Save & Clean** solution (optionally available – not included in the delivery). Place the water tank back in the system.

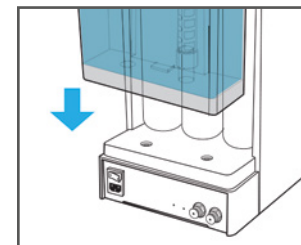
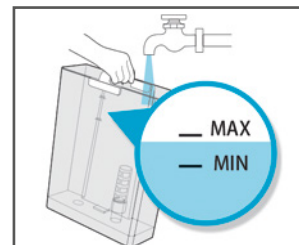

4. Connect the power cord and turn on the machine. **The disinfection process now starts automatically. Wait until the system switches off.**
5. Press the water button to start the water outflow and remove the water from the outlet about 0,1 litre of water. Wait until the system switches off and then let the unit rest for **approx. 10 – 20 minutes**. Run approx. 0,1 litre so that the active ingredient can enter the entire system. **Repeat this process 3 – 4 times.**

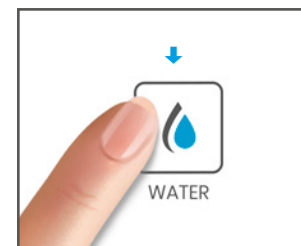
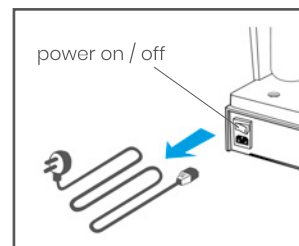

6. Switch off the device and remove the power cord. **Replace the cartridges D with the filters no. 1 and 2** by turning in the direction indicated.

! ATTENTION: SAFETY INSTRUCTIONS (smardy blue Save & Clean Disinfection)! smardy blue Save & Clean is the most effective disinfection system for small water filter systems (approved under the German Potable Water Ordinance 2001). Please read the use and safety instructions on the package insert.

After the disinfection process it is necessary to flush the system with cold tap water. Therefore let at least flow 3 full water tanks through the device. This waste water is not for consumption. In addition, it is advisable to clean the filter sleeves several times with cold tap water, let them dry and then use them for the re-occurring disinfection process by storing them away safely. Repeat the described procedure at regular intervals (at least every 3 months).

TROUBLESHOOTING & RECYCLING

The system stops when an error code appears in the display and only continues the process when the error has been fixed.

Automatic „recovery“ function:

Turn off the power and disconnect the power cord. Wait 10 seconds and reconnect the power cable to the power supply and switch the device on again. If the error code appears again, please contact the customer service for problem solving.

Code	Error	Solving
E1	Pressure pump defective.	Please contact the customer service.
E2	Float defective.	Please contact the customer service.
E3	Temperaturesensor defective.	Please contact the customer service.
E4	Exhaust valve defective.	Please contact the customer service.
E5	Water is leaking.	Please contact the customer service.
E6	Pump defective.	Please contact the customer service.
E7	Pressure pump runs permanently.	Switch the device on again. If the error code appears again, please contact the customer service.
E8	Heater defective.	Please contact the customer service.
Others		Please contact the customer service.

The careful use of natural resources and waste avoidance are particularly important to us. **Would you like to dispose of your old device or filter cartridges?**

We take care of the disposal! Here you will find more information:

smardy-blue.com/recycling



DISPOSAL NOTE: The symbol of the „crossed-out wheeled bin“ on electrical and electronic equipment indicates that you must not dispose of this equipment with domestic waste. Separate collection of old appliances is necessary for the environmentally friendly disposal of hazardous components, the recovery of recyclable materials and the possibility of reusing them.

CUSTOMERS FAQ

Question: When do which filter have to be replaced and how much do they cost?

Answer: Filter cartridges no. 1 and 3 are replaced every 6 months for hygienic reasons and filter no. 2 RO membrane every 12 months. The costs can be found on the product page in our online shop at smardy-blue.com/onlineshop

Question: Can the device also be connected to the water supply system?

Answer: Yes. Information about different type you will find on page 20.

Question: How is the filtration rate?

Answer: Depending on the quality of the tap water up to 95 %.

Question: Filter 5-stage, although there are only 3 filters?

Answer: In cartridges no. 1 and no. 2 there are 2 filters each plus the reverse osmosis membrane in filter cartridge no. RO.

Question: What happens with the waste water?

Answer: The water is cleaned and the waste water is returned to the external water tank.

Question: Is the pure water cooled (degrees?) or does „cold osmosis water“ mean room temperature?

Answer: Room temperature. The appliance can warm up the pure water at the touch of a button.

Question: Are the replacement filters easy to get? Long term?

Answer: Yes. All replacement filters are always available in our online shop at smardy-blue.com/onlineshop and can be ordered.

Question: Is there any concern with hot water which can get through the plastic hoses flows, are all materials bpa free?

Answer: Yes. All materials are BPA free and according to EN-1641 (formerly DVGW) guidelines certified.

Question: How much time does the appliance need for 1 litre water filtration?

Answer: Between 4 und 6 minutes.

Question: In which range are the „ppm OUT“ values in reality?

Answer: Depending on the quality of the tap water, the „ppm output value“ is approximately between 30 - 45.

Question: Does the system reduce the sodium value of tap water?

Answer: The 5-stage filter system filters almost all foreign substances from the water and also lowers sodium.

Question: What brand is the membrane from?

Answer: USA DOW Filmtec™ 75 GPD RO membrane.

JustMore GmbH & Co. KG grants a 24 months guarantee from the date of purchase on all material and workmanship defects of the device (excluding all filters, membranes and storage containers).

In case that problems should occur with your device during or after the guarantee period, please contact our customer service at **info@smardy-blue.com** or by phone **+49 (0) 8232 8088325 (chargeable)**.

JustMore GmbH & Co. KG KG shall not be liable for consequential damages which arise from using the device.



With the warranty extension you protect yourself against unexpected repair costs. For this purpose, the product must be registered on the smardy blue website before the warranty claim is reported and proof of regular maintenance and care (filter change) is required.

smarly blue does not provide any warranty for damages caused by improper use, improper handling, incorrect installation, normal wear and tear as well as insufficient or incorrect care and maintenance work on the product.

- Technical changes subject to reservation -

EXPLANATION OF BUTTONS



All-round service:

Free expert advice and technical support before and after the purchase. We are happy to help you and are at your disposal with advice and support.



Health & balance:

Water is the key to vitality and life force. smardy blue makes your drinking water a source of energy. Drink the best water for a healthy and fulfilled life.



Modern filter technology: Many water dispensers have a simple filter. To get the purest water, more is needed. That is why smardy blue uses three highly developed filter technologies, in a 5-step process to ensure the purity of your water.



Pure water:

Osmotic water is about as pure as the ice on the glaciers. Feel the distinctiveness and clarity of pure water.



ECO: No more trips to the beverage store and long transport routes for the delivery of thousands of water bottles. Simply tap your drinking water at the water bar and make a contribution to saving valuable resources for yourself and the environment.



Activated carbon block filter: Natural and safe – made of coconut shells contains activated carbon a highly efficient and gentle effect. It is a filter for chlorine, chemicals and other harmful organic compounds.



Just clean:

Chalk, viruses, bacteria, microplastics, medicine residue, nitrates, chlorine, uranium, heavy metals, pesticides, fungicides etc. are filtered out up to 95 %.



QuickChange technology:

Filter change in two minutes. Easy filter change thanks to QuickChange technology. All filters can be easily changed by yourself.



Reverse osmosis membrane:

Innovative technology and reliable Quality guaranteed by DOW FILMTEC™ almost 100 % pure water.



Sterilisation by UV light: UV light is the solution for contaminated water through germs, bacteria and fungi. smardy blue UV systems (integrated into the water bar series noura™, zagora™, tata™) offer the perfect protection and provide secure access to pure water.



Decalcification: Clean and decalcify your water bar regularly. The automatic smardy blue decalcification program (integrated in the water bar series noura™, zagora™, tata™) helps you with maintenance and extends the life of your device.



OneTouch button: Easy operation at the touch of a button. Through an innovative SMART TOUCH display can be set to parental control, display for water and filter change and water values (TDS) of the pipeline and osmosis water simply control.



Table top unit:

The eye-catcher of your kitchen. The smardy blue water bar is a table-top osmosis device complete without hoses or connections.



Fixed water connection:

The smardy blue water bar can be connected directly to your water supply in just a few steps. The fresh and process water is connected separately to the water bar.



Water tank:

The internal storage tank has a capacity of 1 litre and enables the quick and flexible withdrawal of pure water without long waiting times.



Temperature regulation

Our gentle and fast method of water heating guarantees the perfectly balanced temperature and unlimited tea enjoyment.



Purest water for your baby:

Whether at lunchtime or half past three in the morning. The milk bar is open 24 hours a day and provides your little darling with pure and perfectly tempered water.



Water heater:

In addition to the dosage of your tea, the right water temperature depending on the type of tea used, brewing time and personal taste must also be taken into account.



Tea function: Thanks to the innovative capsule system and the adjustable water temperature the preparation of tea becomes child's play. Together with the soft, lime-free water your tea turns into a pure pleasure.



Coffee function: The integrated coffee function allows you to prepare your favourite morning drink quickly and easily. In addition, the reusable capsule system saves resources and avoids unnecessary aluminium waste.



Construction:

Robust, versatile, safe. Durable components and reliable technology characterize our devices just as much as the simple and practical handling.



Flexible application possibilities:

Whether in the kitchen, in the office, on the bedside table or even when travelling. Our water bars accompany you and give you the security of having pure water at all times.

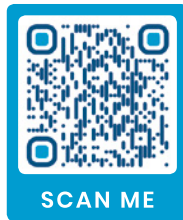

For general information about smardy blue zagora™:

- ✓ Free expert advice before and after the purchase
- ✓ Service Hotline phone: **+49 (0) 8232 8088325** (chargeable)
- ✓ Service Video: **[smardy-blue.com/zagora-hinweise](https://www.smardy-blue.com/zagora-hinweise)**



Georg-Pfandzelter-Str. 1 • 86830 Schwabmünchen
Germany • www.smardy-blue.com